

BRONX RIVER WATERSHED

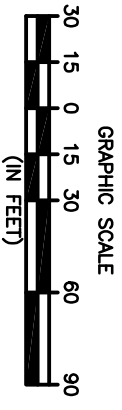
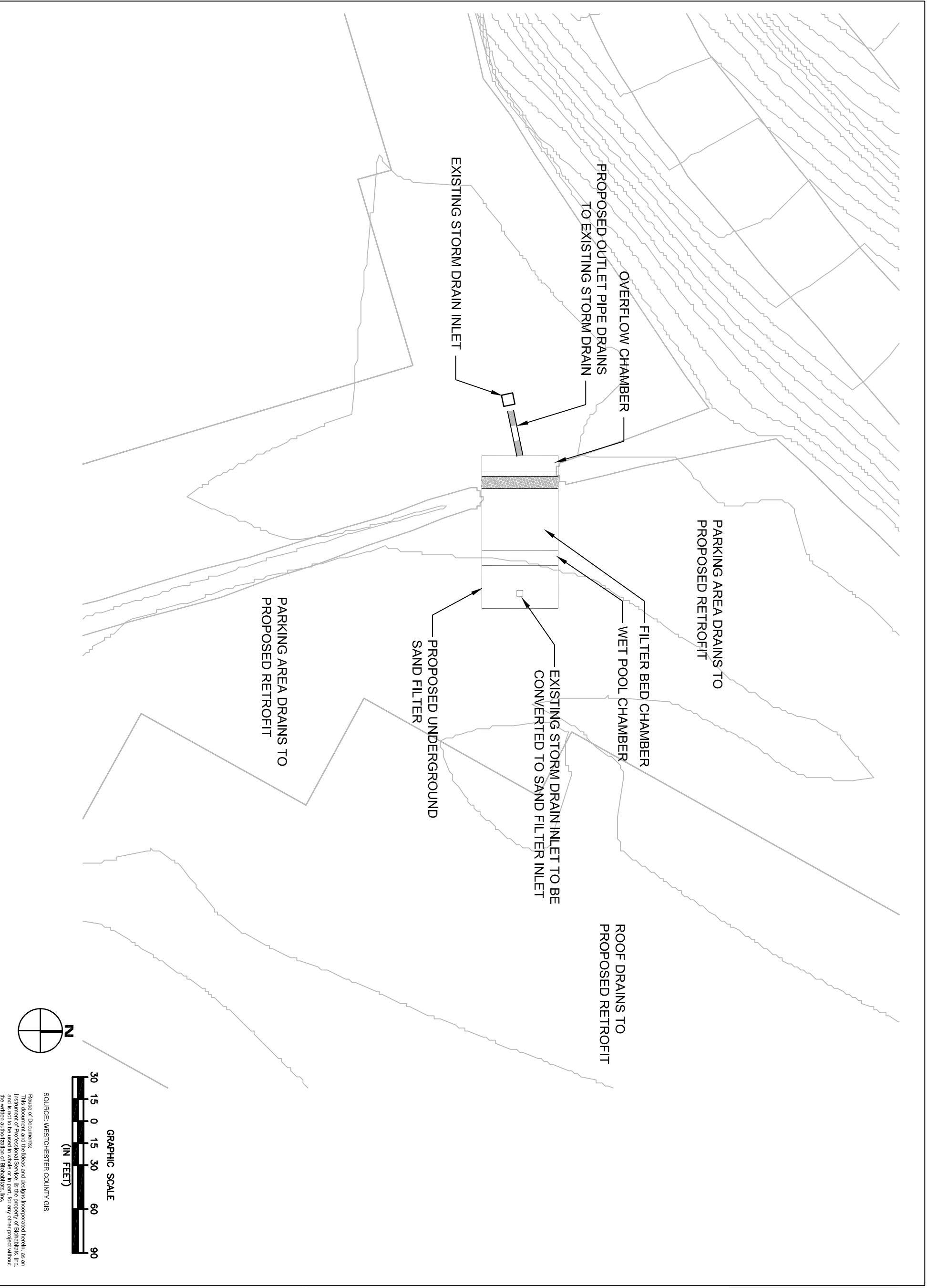

SOURCE: WESTCHESTER COUNTY GIS

Release of Documents:  
The information, data, ideas and designs incorporated herein, as an instrument of Professional Service, is the property of Biohabitats, Inc. and is not to be used, in whole or in part, for any other project without the written authorization of Biohabitats, Inc.

**BRONX RIVER  
WATERSHED**  
FULTON BROOK

TITLE:  
CONCEPTUAL PLAN FOR  
STORMWATER RETROFIT IN  
THE PARKING LOT AT TJ MAXX  
SHOPPING CENTER ON  
CENTRAL AVENUE,  
GREENBURGH

PROJECT NO.:	05039A01	SCALE:	1" = 30'-0"
DATE:	08/08/07	DRAWN BY:	SSJ/JPW
		CHECKED BY:	JRE/WB

Center For Watershed Protection  
8300 Maids St., Second Floor  
Ellicott City, MD 21043-4605  
tel: 410.554.0150 fax: 410.554.0168  
www.cwp.org/610.554.0150

Biohabitats, Inc.  
The Stables Building  
2087 Clapper Park Road Baltimore MD 21211  
tel: 410.554.0150 fax: 410.554.0168  
www.biohabitats.com

DATE: 11.02.07  
ISSUES / REVISIONS:  
08.08.07 REVISIONS:  
CONCEPT